

Product Dimensions:

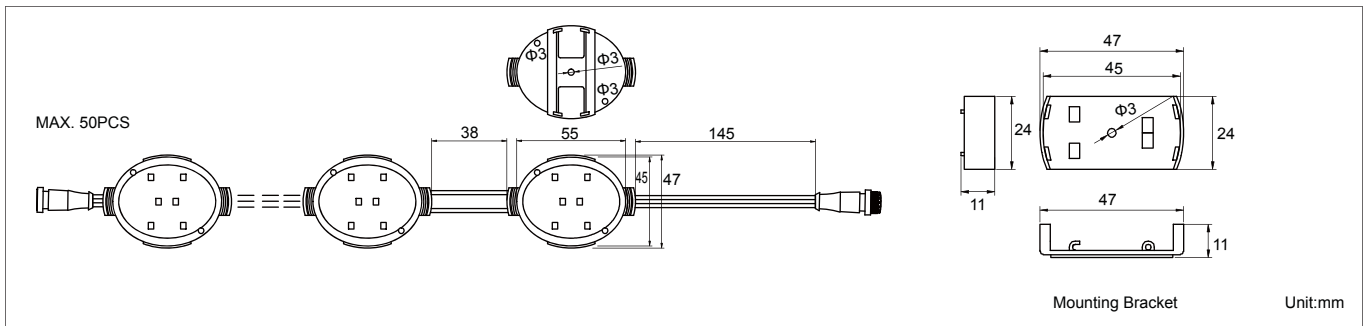

Luminous Intensity Distribution Diagram:

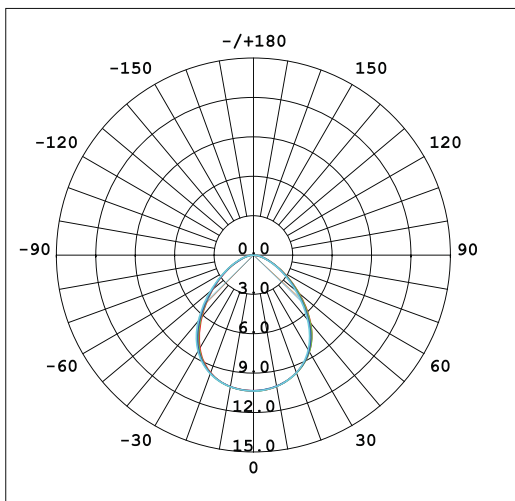

Lux Distribution:

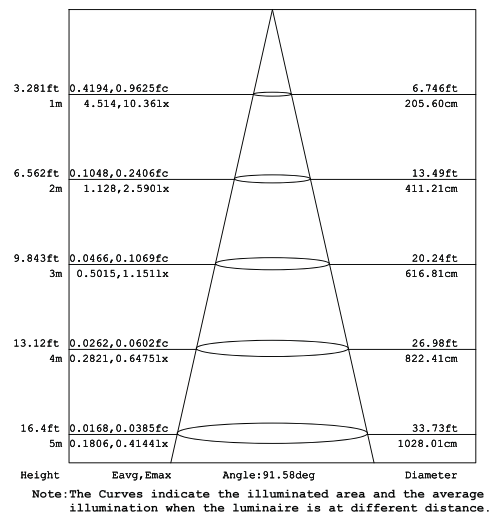

Manufacturing Quality Standard:

- ISO 9001:2008

LED Luminaire Standard:

- EN/IEC 60598-1
- EN/IEC 60598-2-1
- EN/IEC 60598-2-2
- EN/IEC 60529
- EN/IEC 62471-2
- IEC 62612
- EN/IEC 60968
- IEC 62560
- EN/IEC 60061-1
- EN 13032-1
- EN 13032-2
- EN/IEC 62471
- EN/IEC 60825
- EN 60061-1

Electronic Driver Standard:

- EN/IEC 61347-1
- EN/IEC 61347-2-13
- EN/IEC 62384
- EN/IEC 61000-3-2
- EN/IEC 61000-3-3
- EN/IEC 61547
- EN 55015(CISPR 15)

LED Module Standard:

- IEC 62031
- IEC 60838-2-2

LED Light Photometric Standard:

- CIE; TM14; LM-75; IES; LDT; CEN; CIB

RoHS Standard:

- EPA3050B
- EN 1122B
- IEC 62321
- EPA3052
- EPA3060A
- EPA7196A
- EPA3540C
- EPA8270D

LED Luminaire Performance:

- Switching cycle: 100,000x

Features:

- Life of LED:50,000 hours
- Display to 16.7 million colors
- 256 gradations for RGB individually
- Excellent waterproof performance
- Surface electrostatic spray coating
- Off line control / PC control
- Resist UV design
- Easy to install

Applications:

- Outdoor plaza
- The house of contours
- Bridges
- Landscape lighting



Specifications:

Power	2W
Qty of LEDs	6PCS(SMD 5050)
Pixels (Sections) per Luminaire	1Pixel
Input Voltage	DC 15V
Control Protocol	TTL (IC 3001)
Beam Angle	125°
Color Rendering Index	80@2700K / 3000K / 4000K / 5000K / 6500K
Luminaire Efficacy	*75lm/w(2700K),* 80lm/w(3000K),* 90lm/w(4000K),* 95lm/w(5000K),*100lm/w(6500K), *20lm/w(RGB),*10lm/w(Blue 450nm~160nm),*50lm/w(Red 620~630nm),*65lm/w(Green 520~530nm),*30lm/w(Yellow 589~595nm), *50lm/w(RGB)
LED Source Efficacy	*95lm/w(2700K),*100lm/w(3000K),*110lm/w(4000K),*115lm/w(5000K),*120lm/w (6500K), *35lm/w(RGB),*20lm/w(Blue 450~460nm),*70lm/w(Red 620~630nm),*80lm/w(Green 520~530nm), *50lm/w(Yellow 589~595nm),*80lm/w(RGB)
Operating Temperature	-20~50°C
LED Sources	Taiwan Epistar
Life Time	50,000 Hours at Ta=40°C
Operating Humidity	10%~90%RH
Finishing Materials	Polycarbonate
Body Color	Matt Black
RAL Color Code	9017
Net Weight	50g

Ordering Part No.:

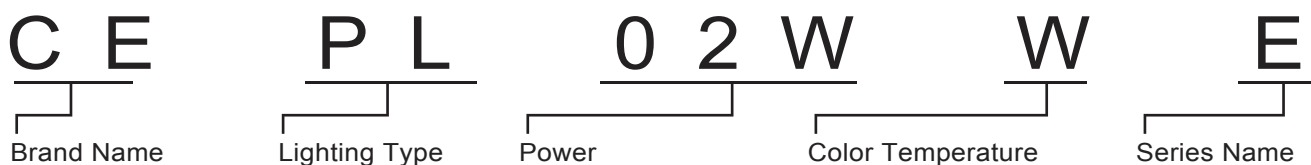

Brand Name	Lighting Type	Power	Color Temperature	Series Name
CE: CELEX	PL: Pixel Light	02W	O: 2700K W: 3000K N: 4000K D: 5000K C: 6500K R: Red(620~630nm) G: Green(520~530nm) B: Blue(450~460nm) Y: Yellow(590~595nm) F: Full Color(RGB)	E: EGG Series

Installation Guide:

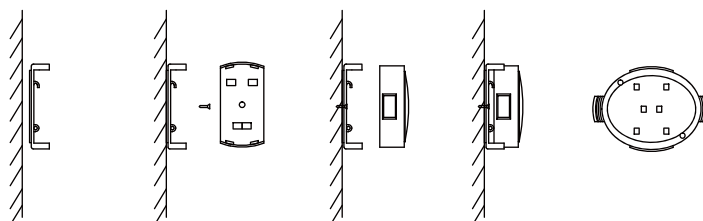

Off-line DMX Controllers:



P/N: DMXSC-03 Sub-Controller



P/N: DMXMC-03 Master Controller

DMXSC & DMXMC Product Dimensions:

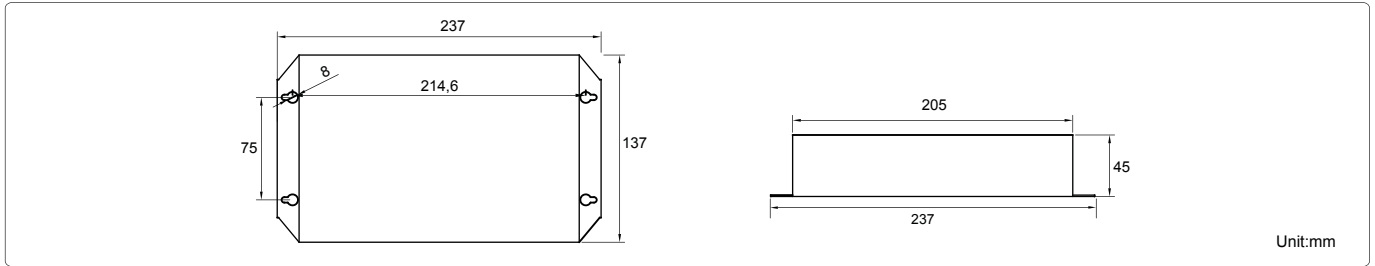

Installation Instructions For Point Light Application--Off-line Control

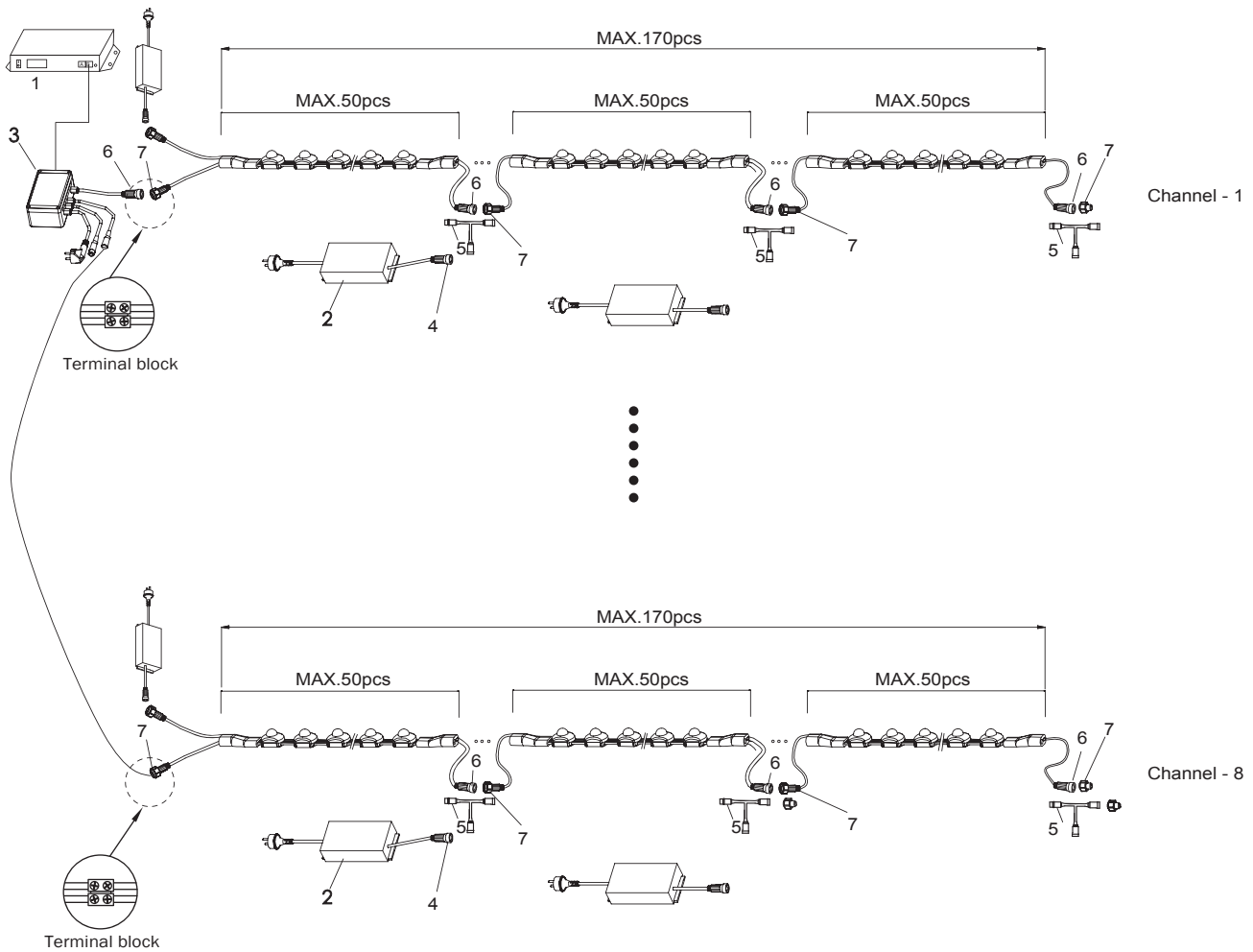

- 1. Master controller (DMXMC-03)
- 2. Switching power supply(DC15V)
- 3. Sub controller (DMXSC-03)
- 4. I-cable with connector IP65 (Φ20mm)

- 5. "T" connector IP65 (Φ20mm)
- 6. 3Pin signal female connector IP65 (Φ20mm)
- 7. End cap IP65 (Φ20mm)