

LED Linear Light ATHENS Series



Description:

ATHENS series LED Linear light is a outdoor linear fixture available in two dimensions: 250mm / 500mm / 1000mm. It has monicolor or RGB LEDs able to be controlled by DMX / 1~10V / leading edge dimming. This product suits perfectly to architectural contour lighting on buildings, ornamental colour washing effects or integration instructors and facades. It's as well a great alternative to urban furniture due to its IP65 protection rating.

Features:

- Comply with standard DMX 512(Digital Multiplex) controller system
- Built-in DMX address IC for IP writing
- Display to 16,777,216 colors
- Frame per second:>100 FPS
- Dimmable range:0~255 steps
- 256 gradations for RGB individual
- Life time:50,000 hours
- Built-in constant current driver with PWM signal > 400Hz
- 6063 aluminum alloy housing with anode oxidation
- Unique polycarbonate milky cover diffuser for uniform illumination
- No dark areas at clear and caps in straight line array
- Unique XLR5 5Pin IP68 female/male connector
- The cable can be hidden in linear chamber
- Convenient installation with elliptic holes

Applications:

- Facade Lighting
- Building Outline
- Bridge Outline
- Video Wall

ATHENS Series



Product Dimensions:

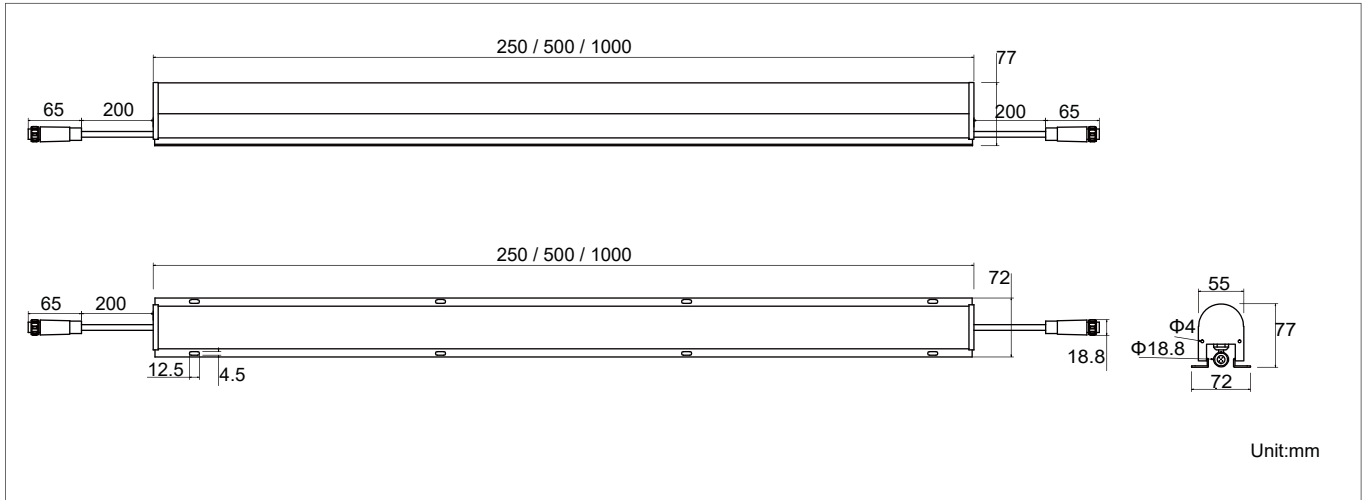

Luminous Intensity Distribution Diagram:

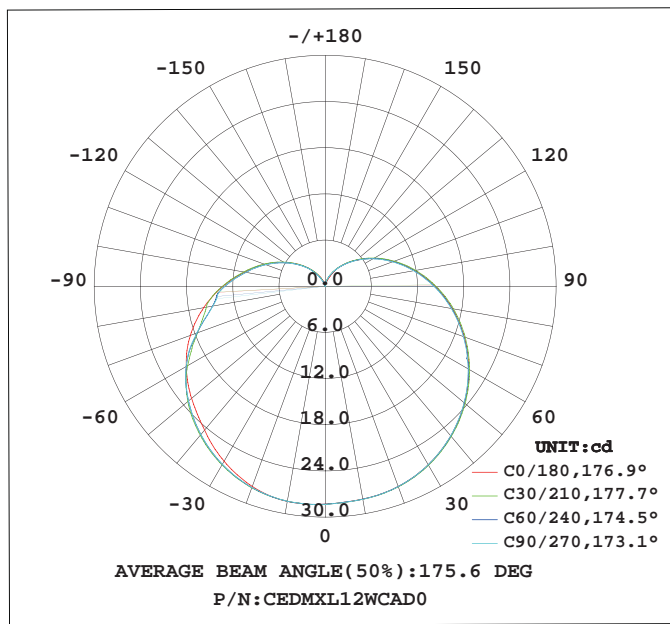

Lux Distribution:

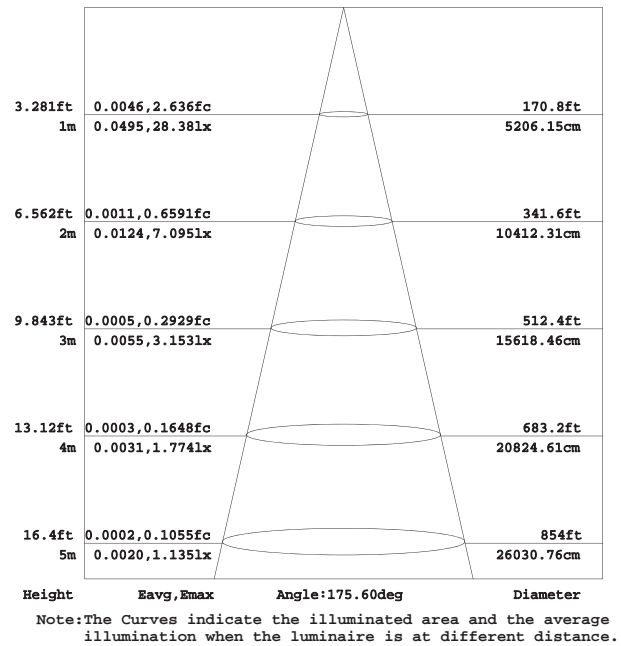

Manufacturing Quality Standard:

- ISO 9001:2008

LED Luminaire Standard:

- EN/IEC 60598-1
- EN/IEC 60598-2-1
- EN/IEC 60598-2-2
- EN/IEC 60529
- EN/IEC 62471-2
- IEC 62612
- EN/IEC 60968
- IEC 62560
- EN/IEC 60061-1
- EN 13032-1
- EN 13032-2
- EN/IEC 62471
- EN/IEC 60825
- EN 60061-1

Electronic Driver Standard:

- EN/IEC 61347-1
- EN/IEC 61347-2-13
- EN/IEC 62384
- EN/IEC 61000-3-2
- EN/IEC 61000-3-3
- EN/IEC 61547
- EN 55015(CISPR 15)

LED Module Standard:

- IEC 62031
- IEC 60838-2-2

LED Light Photometric Standard:

- CIE; TM14; LM-75; IES; LDT; CEN; CIB

RoHS Standard:

- EPA3050B
- EN 1122B
- IEC 62321
- EPA3052
- EPA3060A
- EPA7196A
- EPA3540C
- EPA8270D

LED Luminaire Performance:

- LM-80-08
- Switching cycle:100,000x

LED Linear Light ATHENS Series



Specifications:

Power	12W	6W	3W
Size (Length)	1000mm	500mm	250mm
Net Weight	1.02kg	0.75kg	0.5kg
Qty of LEDs	48PCS	24PCS	12PCS
Pixels(Sections) per Luminaire	8Pixels (Max)	4Pixels (Max)	2Pixels (Max)
DMX512 Channel per Luminaire	1 Channel (Mono Color) 3 Channels (RGB) 4 Channels (RGBW) 8x3 Channels (RGB) 8x4 Channels (RGBW)	1 Channel (Mono Color) 3 Channels (RGB) 4 Channels (RGBW) 4x3 Channels (RGB) 4x4 Channels (RGBW)	1 Channel (Mono Color) 3 Channels (RGB) 4 Channels (RGBW) 2x3 Channels (RGB) 2x4 Channels (RGBW)
Input Voltage	DC 24V		
Control Protocol(optional)	DMX 512 / 1~10V / Triac Dimming Leading Edge		
Beam Angle	175°		
Color Rendering Index	85@2700K / 85@3000K / 85@3500K / 85@4000K / 80@5000K / 75@6500K		
Color	Monocolor	RGB	RGBW
Luminaire Efficacy (Max)	*75lm/w(2700K), *80lm/w(3000K), *90lm/w(4000K), *95lm/w(5000K), *100lm/w(6500K),	*10lm/w(Blue 450~460nm), *50lm/w(Red 620~630nm), *65lm/w(Green 520~530nm), *30lm/w(Yellow 589~595nm)	*40lm/w max *R: 620~630nm *G: 520~530nm *B: 480~485nm
LED Source Efficacy (Max)	*90lm/w(2700K), *95lm/w(3000K), *110lm/w(4000K), *115lm/w(5000K), *120lm/w(6500K),	*20lm/w(Blue 450~460nm), *70lm/w(Red 620~630nm), *80lm/w(Green 520~530nm), *50lm/w(Yellow 590~595nm)	*75lm/w max *R: 620~630nm *G: 520~530nm *B: 480~485nm
LED Source	Samsung / Taiwan Epistar		
Life Time	50,000 Hours at Ta=40°C		
Operating Temperature	-20°C~70°C		
Operating Humidity	10%~90%RH		
Finishing Materials	Aluminum & Polycarbonate		
Body Color	Sliver / Matte Black / Matte Grey / Tailor-made		
RAL Color Code	9006 / 9017 / 7042 /		

Ordering Part No.:

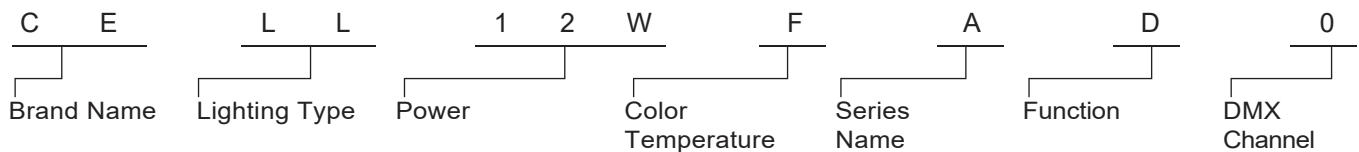

Brand Name	Lighting Type	Power	Color Temperature	Series Name	Function	DMX Channel
CE: CELEX	DMXLL: DMX Linear Light	12W 06W 03W	O: 2700K W: 3000K N: 4000K D: 5000K C: 6500K R: Red(620~630nm) G: Green(520~530nm) B: Blue(450~460nm) Y: Yellow(590~595nm) F: Full Color(RGB) FO: RGBO(2700K) FW: RGBW(3000K) FN: RGBN(4000K) FD: RGBD(5000K) FC: RGBC(6500K)	A: ATHENS Series	D: DMX 512 +DC 24V L: DC 24V T: Triac Dimming Leading Edge V: 1~10V Dimming +DC 24V	0 1 3 4 4X3 4X4 8X3 8X4



LED Linear Light ATHENS Series

DMX Controllers:

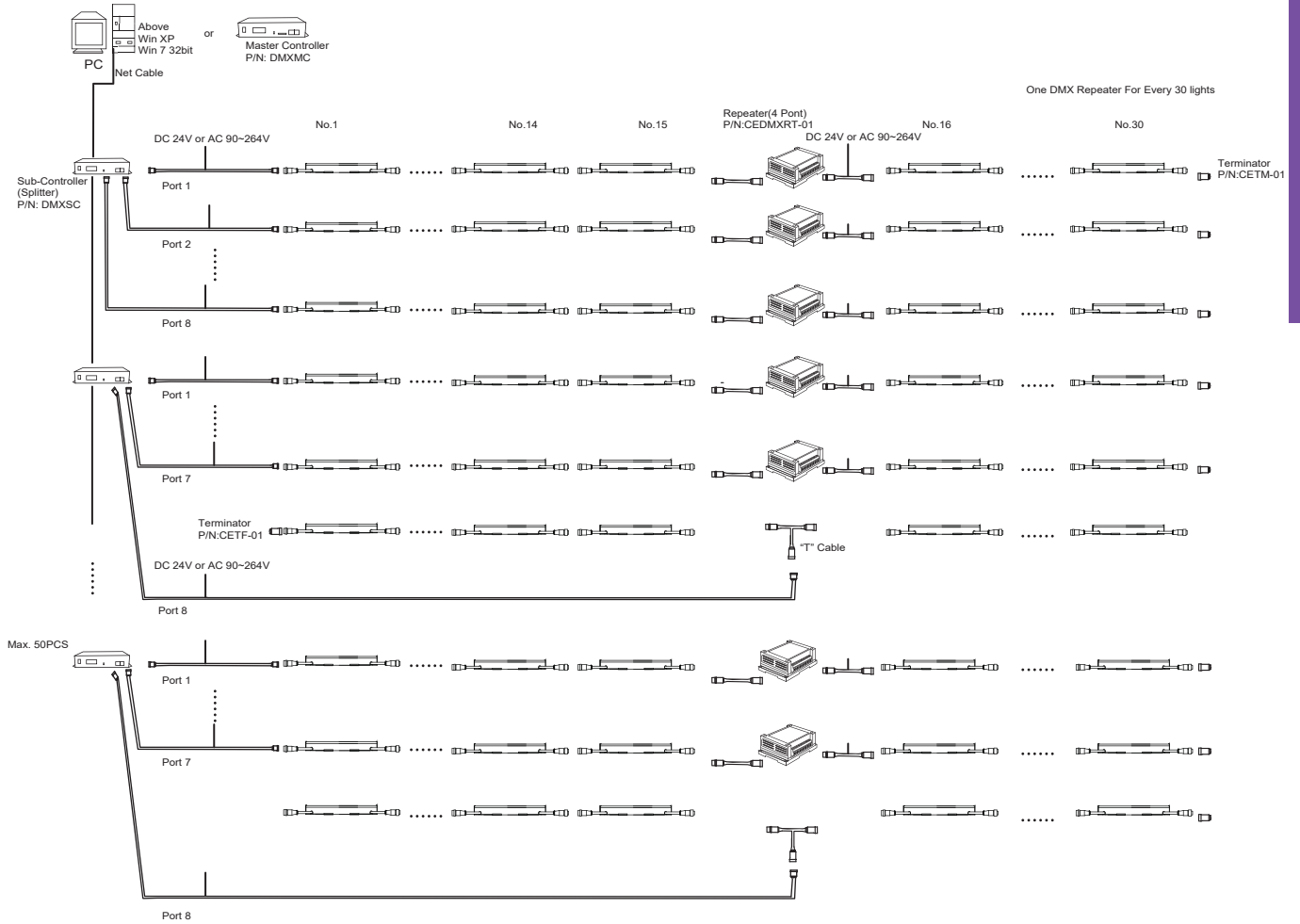

Accessories:



DMX Repeater
P/N: CEDMXRT-01

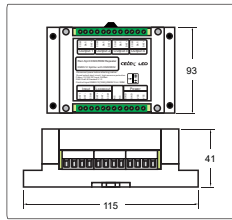

Master Controller
P/N: DMXMC



Sub-Controller (Splitter)
P/N: DMXSC

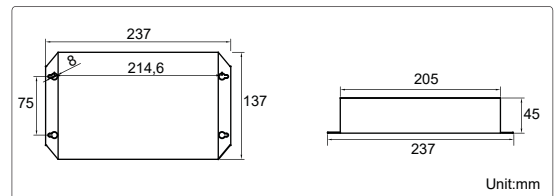

Female and Male 5 Pin Cable
P/N:C-5PIN-L-FM



3 channel connectors
5 Pin (2 Male and 1 Female)
P/N:C-5PIN-T-2MIF